

**SAFETY FIRST**

**ALWAYS KEEP THE GUN POINTED IN A SAFE DIRECTION**  
**ALWAYS KEEP YOUR FINGER OFF THE TRIGGER UNTIL READY TO SHOOT**  
**ALWAYS KEEP THE GUN UNLOADED UNTIL READY TO USE**

**SHORTY SCOPE MOUNT  
PRODUCT MANUAL**

**PARTS LIST**

1	MOUNT BASE	× 1
2	D33 CAP	× 1
3	D30 CAP	× 1
4	CLAMP	× 2
5	M5×20 T25 SCREW	× 2
6	M4×10 T15 SCREW	× 8
7	VIAL	× 1
8	M6 GRUB SCREW	× 1

**REQUIRED TOOLS**



TORQUE WRENCH / T15 & T25 BITS



T15 & T25 SCREWDRIVERS

**RELATED PRODUCTS**

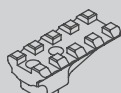

SLO005  
ScopeLink™ RAIL H15

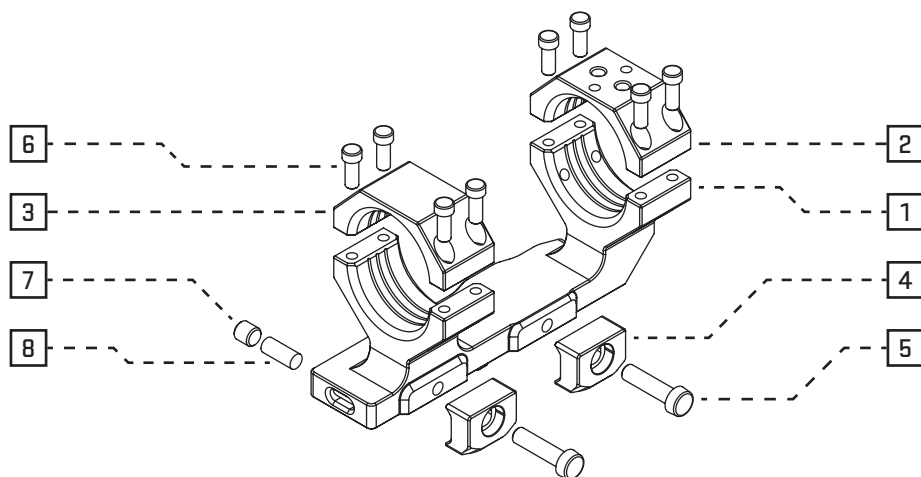

**MAJOR FEATURES**

- Accessory interface via ScopeLink™ system (FIG.A)
- CNC machined from single 7075-T651 aluminium billets
- Hardcoat anodizing / MIL-A-8625 Type III

**INSTALLATION INSTRUCTIONS**

1. Properly place the mount base on the rail and slide it toward the muzzle until the recoil lug stops against the tooth (FIG.B).
2. While keeping the base in position, attach the clamps with M5×20 T25 screws applying a slight torque. **Make sure the clamps are correctly oriented, with the bigger chamfer downward.**
3. According to the intended application, tighten the clamping screws to the following torque value range:  
**6 - 8 Nm [53.1 - 70.8 in-lb] (never exceed).**
4. Place the scope into the mount then attach the caps and start M4×10 T15 screws into the base as shown (FIG.C).
5. Check for a comfortable eye relief and level the scope.
6. Make sure the gaps on either side of the clamp are kept even (FIG.D) then tighten the caps to the following torque value ranges:  
**Front D33 cap 1.7 - 2.03 Nm [15 - 18 in-lb], 1.7 Nm [15 in-lb] recommended.**  
**Rear D30 cap 1.7 - 2.03 Nm [15 - 18 in-lb], 1.92 Nm [17 in-lb] recommended.**

**ACCESSORY INSTALLATION INSTRUCTIONS**

1. Properly place the ScopeLink™ accessory in the selected interface.  
Note that the fit allows a slight alignment adjustment.
2. Tighten the T15 M4×10 screws to a max torque value of 2.5Nm [22 in-lb].

**ATTENTION**

**NEVER APPLY THREADLOCKER TO THE SCREWS**  
**PERIODICALLY CHECK SCREWS TIGHTENING**

FIGURE A

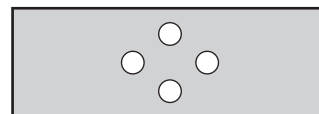

FIGURE B

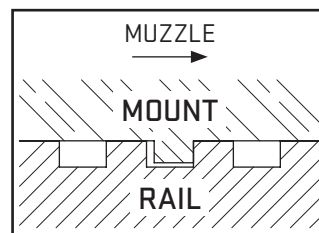

FIGURE C

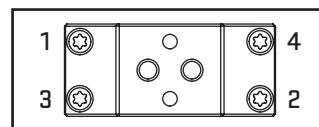

FIGURE D

